

COPYRIGHT
THIS DOCUMENT AND ALL DATA CONTAINED HEREIN REMAIN THE PROPERTY OF O'DALY ARCHITECTS. IT IS SUPPLIED IN CONFIDENCE FOR EVALUATION PURPOSES ONLY UNDER THE CONDITION THAT SAME IS NOT USED, REPRODUCED OR TRANSMITTED IN ANY WAY TO OTHERS WITHOUT WRITTEN CONSENT.

DIMENSIONS
UNLESS OTHERWISE STATED, DIMENSIONS SHOWN ARE IN MILLIMETRES. NO DIMENSIONS TO BE SCALED FROM THIS DRAWING. ALL DIMENSIONS TO BE CHECKED BY THE CONTRACTOR ON SITE AND ANY DISCREPANCIES TO BE REPORTED TO THE ARCHITECT.

PLANNING STAGE DRAWING PROVIDED STRICTLY FOR PLANNING ASSESSMENT ONLY. NOT TO BE USED FOR ANY OTHER PURPOSE.

Apartment drawings show an indicative ground floor level set at zero. Please refer to Architects Site Layout, Site Sections and Engineers drawings for actual ground floor levels related to site levels / O.S. datum.

CHARACTER AREA 2 - PROPOSED FINISHES

External Walls:
Ashlar plaster finish to lower elevations and red brick finish to upper elevations with black brick soldier courses and natural limestone window surrounds and sills. Black brick to external walls of access cores.

Roofs:
Black concrete tile finish to main roofs. White PVC fascia and soffit. Black PVC rainwater goods. Standing seam metal roofs to flat roofs and canopies.

Windows and External Doors:
Double glazed uPVC windows in pebble / cement grey colour. Composite front door unit in selected colour.

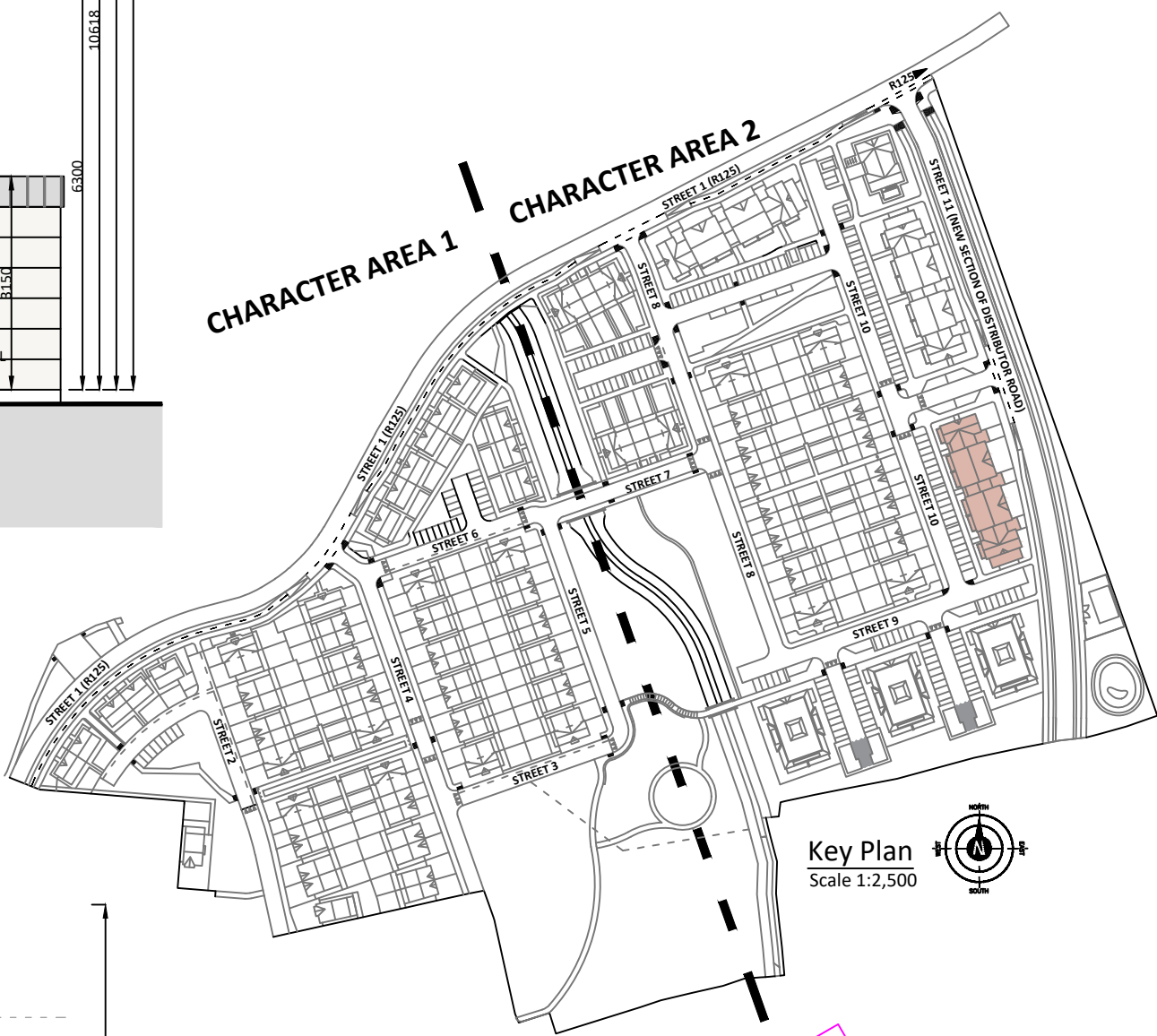

PREVIOUSLY
PERMITTED



ARCHITECT
ACCREDITED IN
CONSERVATION



REGISTERED
PRACTICE

ROSCOMMON OFFICE
3 Warren Drive, Boyle,
Co. Roscommon.
(071) 9662849
(086) 1593876
Email: david@odaly.ie



o'daly architects

MEATH OFFICE
1st Floor, Unit 13 B,
Mullaghboy Ind. Est.,
Navan, Co. Meath.
(046) 9021281
(087) 0925233
Email: ivan@odaly.ie

PROJECT STAGE:	Planning Stage	PROJECT:	Proposed Strategic Housing Development		
OUR REF:	I/20008	LOCATION:	Grange End, Dunshaughlin, Co. Meath		
SCALE:	1:100	CLIENT:	Loughglynn Developments Ltd.		
DATE:	28/04/2020	DRAWING NO:	20008-PL-305	REV:	
DRAWN:	I.o'd	DESCRIPTION:	Apartment Block D Elevations & Section		